



City of Kelso - Residential Site Plan Checklist and Drawing Area

FOR OFFICE USE ONLY

Permit #:

Assoc. App#:

Building and Planning Department

360.423.9922 (office)

360.423.6591 (fax)

City of Kelso

203 S. Pacific Ave., PO Box 819

Kelso, WA 98626

Engineering Department

360.423.6590 (office)

360.423.6591 (fax)

SITE PLAN CHECKLIST AND EXAMPLE

- Scale – Ex.: Scale: 1" = 40'
- North Arrow
- Property Boundaries/Easements/Roads
- Labeled Building Footprint and Driveway
- Setbacks from property lines
- Water/Sewer/Other Utility Lines
- Slope (use contour lines, arrows and % of slope)
- Shoreline and Diking District Information (if applicable)

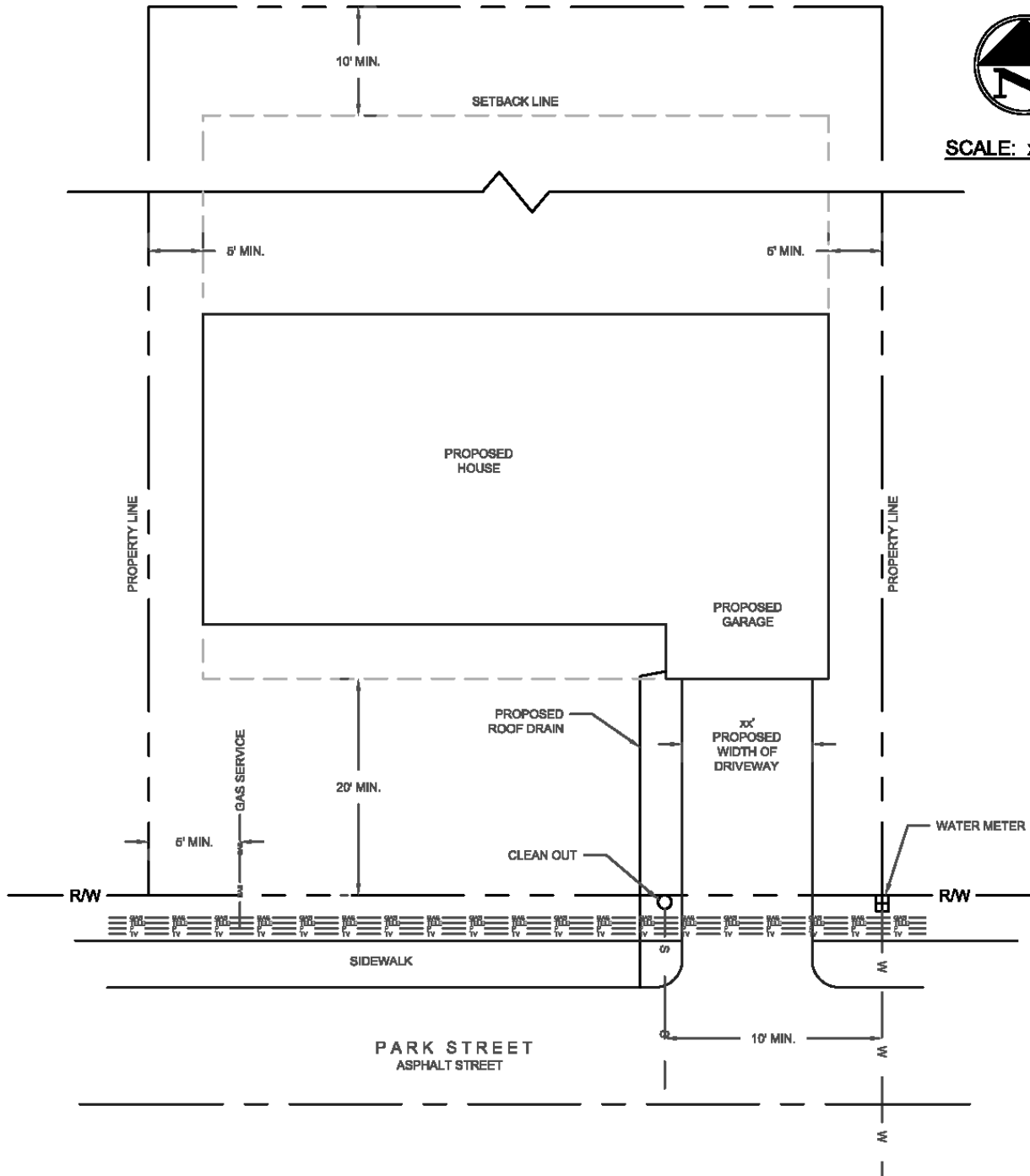

SCALE: x" = xx'



City of Kelso - Residential Site Plan Checklist and Drawing Area

FOR OFFICE USE ONLY

Permit #:

Parent App#:

Building and Planning Department

360.423.9922 (office)

360.423.6591 (fax)

City of Kelso

203 S. Pacific Ave., PO Box 819

Kelso, WA 98626

Engineering Department

360.423.6590 (office)

360.423.6591 (fax)

SITE PLAN CHECKLIST AND DRAWING AREA

- | | |
|--|--|
| <input type="checkbox"/> Scale – Ex.: Scale: 1” – 40’ | <input type="checkbox"/> Setbacks from property lines |
| <input type="checkbox"/> North Arrow | <input type="checkbox"/> Water/Sewer/Other Utility Lines |
| <input type="checkbox"/> Property Boundaries/Easements/Roads | <input type="checkbox"/> Slope (use contour lines, arrows and % of slope) |
| <input type="checkbox"/> Labeled Building Footprint and Driveway | <input type="checkbox"/> Shoreline and Diking District Information (if applicable) |